



Virginia Department of Transportation

Route 240 at 250 Intersection Improvements

Route 250/240/680 Roundabout

Project Location

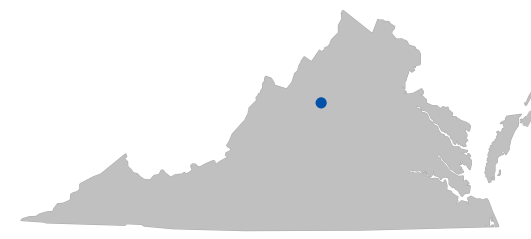

Albemarle County

North Arrow & Scale

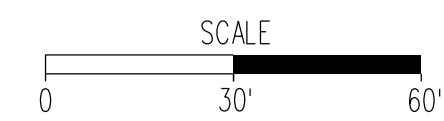
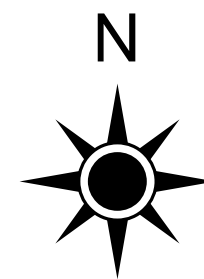

Legend

	Proposed Road		Existing Right of Way
	Existing Bridge		Proposed Right of Way Line
	Truck Apron		Proposed Permanent Easement
	Roundabout Grass Median		Proposed Temp. Construction Easement
	Proposed Curbing/Median		Existing Utility Easement
			Existing Prescriptive Easement
	Property Line		
	Proposed Limits of Construction - Cut		
	Proposed Limits of Construction - Fill		

Contact Information

Harold L. Jones, Jr., PE
Project Manager
VDOT Charlottesville Residency
701 VDOT Way
Charlottesville, Va 22911

Comments may also be sent to:
harold.jones@VDOT.Virginia.gov

Route 250/240/680 Roundabout
Albemarle County, Virginia

State Project Number: 0250-002-957, P101, R201, C501
UPC 111729
Federal Project Number

These plans are unfinished and unapproved and are not to be used for any type of construction or the acquisition of right of way. Additional easements for utility relocations may be required beyond the proposed right-of-way shown on these plans.

Imagery Courtesy of the Commonwealth of Virginia copyright 2009/2010.

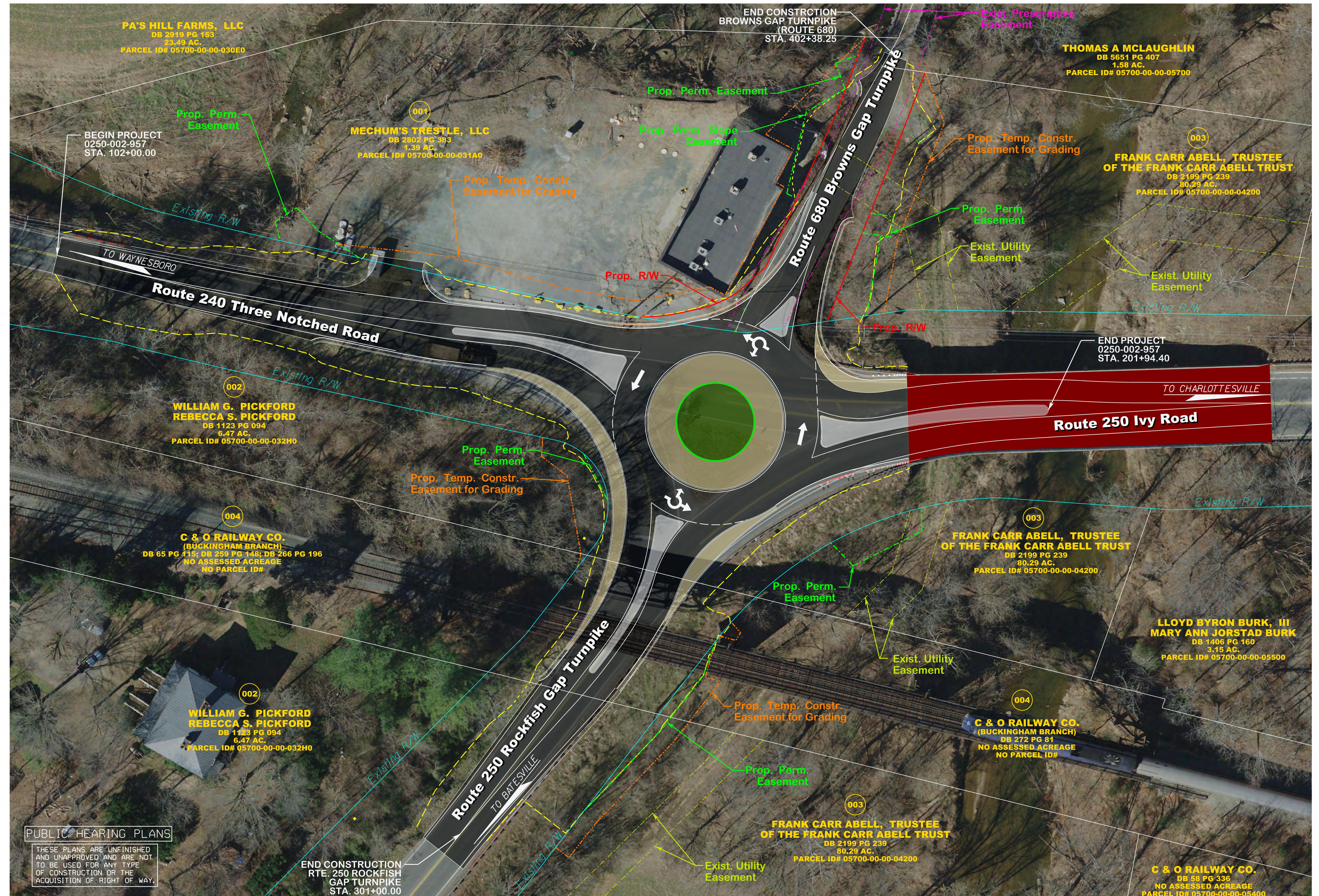

PUBLIC HEARING PLANS
THESE PLANS ARE UNFINISHED AND UNAPPROVED AND ARE NOT TO BE USED FOR ANY TYPE OF CONSTRUCTION OR THE ACQUISITION OF RIGHT OF WAY.

END CONSTRUCTION
RTE. 250 ROCKFISH
GAP TURNPIKE
STA. 301+00.00